

# ColorTAC™ CVA-14

## QUICK START GUIDE

### Unfolding the CVA:

- **To unfold**, Grasp the two filter housings and pull apart until the center linkage is flat.

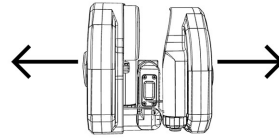

### Batteries:

- CVA-14 takes (2) AA Lithium batteries; standard Alkaline batteries may be used, but will have reduced battery life. The positive (+) end of the battery is inserted first.
- A red light in the eyepiece flashes every two seconds when the batteries are at approximately 20% remaining power.
- **Warning: To prevent potential damage to the CVA-14 never mix old and new batteries or lithium and alkaline batteries, and chose batteries that meet intrinsically safe standards.**

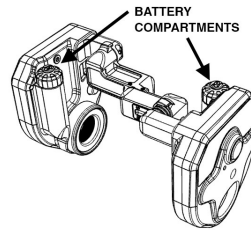

### Power Switch:

- The Power Switch is located on the outside face of the Rear Housing.
- **To turn ON** press the Power Switch for two seconds. A red light in the eyepiece and a green light to the right of the Power Switch will flash three times to indicate that the unit has turned on.
- **To turn OFF** press the Power Switch for two seconds. The red light in the eyepiece and the green light to the right of the Power Switch will flash once to indicate that power is off.

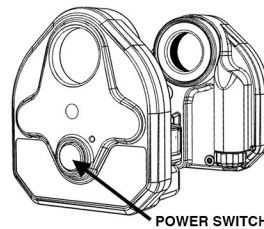

### Mounting the CVA to the PVS-14:

- **To mount** press the Unlocking Button and rotate the Front Filter Housing slightly downwards. Press the PVS-14's eyepiece into its socket on the Rear Filter Housing and swing the Front Filter Housing back so that it captures the PVS-14's objective lens and the Center Linkage locks flat. Rotate the PVS-14's battery compartment until snug onto the rubber bumpers on the top of the Central Linkage.

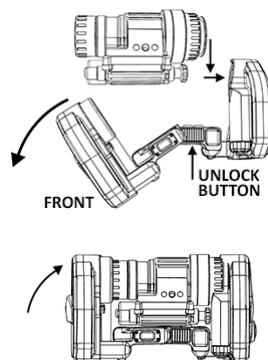

### Monochrome Mode:

- The CVA-14 will deliver a color image down to starlight light levels. In darker conditions such as overcast starlight, the CVA-14 can be switched Monochrome Mode to give a full performance monochrome image.
- **To switch Monochrome Mode ON** press the Power Switch button twice within two second. A red light in the eyepiece will flash once and the filter wheels will stop on clear, unfiltered segments.
- **To switch Monochrome Mode OFF** press the Power Switch button twice again to switch back into color mode.
- Note: when the CVA-14 is in Monochrome Mode, the device's

electronics are still running. To prevent battery drain before storing the device, make sure the CVA-14 is in Color Mode (filters spinning,) then press Power Switch for two seconds to turn the CVA-14 off.

**Color Enhancer:**

- To engage the Color Enhancer rotate the lever counter-clockwise to improve the saturation of colors in the image. In normal conditions, rotate the Lever clockwise.

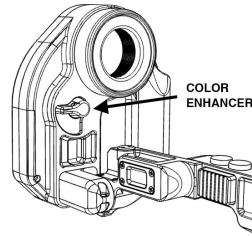

**Operational Precautions:**

- Like the PVS-14, the CVA-14 is a precision electro-optical instrument and should be treated as such. Do not scratch the external optical window surfaces or touch them with your fingers; fingerprints on the windows will degrade image quality. Before cleaning carefully blow off dust and grit. Use lens tissue or micro fiber cloth to clean the windows. Detailed cleaning instructions can be found in the CVA-14 Manual.

**Un-Mounting the CVA:**

- **To un-mount** the CVA-14 from the PVS-14 grasp the PVS-14 and rotate it so that its battery compartment disengages from the CVA's rubber bumpers. While still grasping the PVS-14, press the unlock button and swing the Front Filter Housing outwards, freeing the PVS-14 from the CVA.
- **To fold** the CVA-14, press the unlock button, lift the middle of the Center Spine and then press the two Filter Housings together.

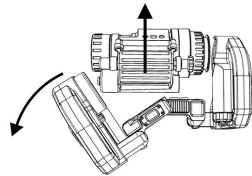

**Warranty:**

The CVA-14 is covered by a one (1) year limited warranty. For full warranty details, please visit: [www.colortacnightvision.com/warranty](http://www.colortacnightvision.com/warranty).

**Export Notice**

**The CVA-14 falls under the control jurisdiction of either the U.S. Department of State, Office of Defense Trade Controls. It is unlawful to export, or to attempt to export or otherwise divert, transfer or sell any hardware or technical data to any foreign person, whether abroad or in the United States, for which a license or a written approval of the United States Government is required, without first obtaining that license or written authorization.**

The ColorTAC CVA-14 is covered by US Patents 6,614,606 B2 , US 7507964 B2, foreign patents and other patents pending

**Chromatra LLC**  
**100 Cummings Center S-231G, Beverly, MA 01915 USA**  
**[www.colortacnightvision.com](http://www.colortacnightvision.com)**  
**+1.978.473.7005**